

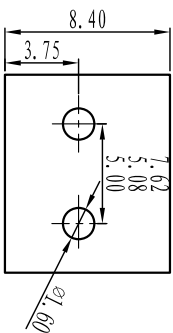

CIXI WANJIE ELECTRONIC CO., LTD

product specification

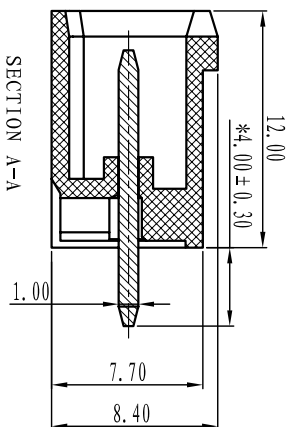
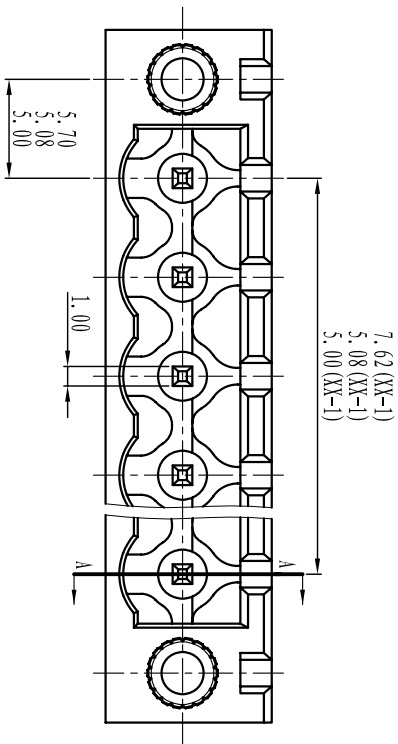

**Electrical**  
 Standard: UL IEC  
 Rated voltage: 250V 320V  
 Rated current: 10A 20A  
 Contact resistance:  $20m\Omega$   
 Withstanding voltage: AC2000V/1Min  
 Insulation resistance: 5000M $\Omega$ /DC1000V

**Mechanical**  
 Temp. Range:  $-40^{\circ}C^{+}+105^{\circ}C$   
 MAX Soldering:  $+250^{\circ}C$ , for 5 Sec

Pitch: 5.00mm, 5.08mm, 7.62mm  
 Poles: 2P-24P  
**Material**  
 Housing: PA66, UL94V-0  
 Pin header: Brass, Tin plated  
 Nut: M2.5 Brass

TOLERANCES EXCEPT AS NOTED

	linear dimension	fillet	chamfer	$\nabla$ short angle sid	$\equiv$	$\square$	$\parallel$	$\perp$
variable range	over 6 to 30	over 30 to 120	over 120 to 480	over 480 to all	over 6 to 10	over 10 to 50	over 50 to 120	over 120 to all
tolerance	$\pm 0.1$ to 6	$\pm 0.2$ to 30	$\pm 0.3$ to 120	$\pm 0.5$ to 480	$\pm 0.2$ to 6	$\pm 0.5$ to 10	$\pm 1$ to 50	$1^{\circ}$ to 30'

HOW TO ORDER

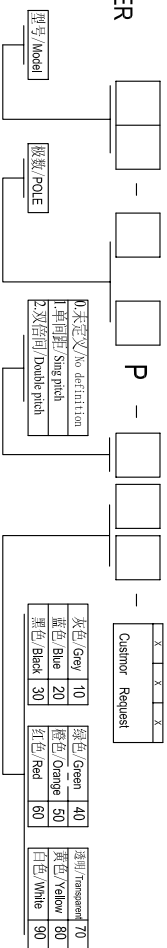

UNITS mm SIZE A4 SCALE



CIXI WANJIE ELECTRONIC CO., LTD

NAME WJ2DNC1M-XP-11Y-00A

FIRST ANGLE PROJECTION

