

LOOSE PIECE		TAPE MOUNTED		SPECIFICATIONS						
MATERIAL NUMBER	ENGINEERING NUMBER	MATERIAL NUMBER	ENGINEERING NUMBER	STUD SIZE	"S" ±.005 [0.13]	"W"	"C" MIN.	"E" MAX.	"L" MAX.	"H"
191930254	F-366-10	---	---	10	.198 [5.03]	.665±.013 [16.89±0.33]	.520 [13.21]	1.028 [26.11]	1.385 [35.18]	1.172 [29.77]
191930258	F-366-12	---	---	12	.515 [13.08]					
191930261	F-366-14	191930263	F-366-14T	14	.265 [6.73]					
191930264	F-366-38	191930266	F-366-38T	38	.390 [9.91]					
191930267	F-366-56	191930269	F-366-56T	56	.328 [8.33]					
191930270	F-366-76	---	---	76	.453 [11.51]					
191930273	F-367-10	191930274	F-367-10T	10	.198 [5.03]	.475±.010 [12.06±0.25]	.520 [13.21]	1.028 [26.11]	1.288 [32.72]	1.172 [29.77]
191930275	F-367-14	191930277	F-367-14T	14	.265 [6.73]					
191930278	F-367-56	---	---	56	.328 [8.33]					
191930281	F-369-12	---	---	12	.515 [13.08]	.885±.010 [22.48±0.25]	.989 [25.12]	1.497 [38.02]	1.970 [50.04]	---
191930283	F-369-38	---	---	38	.390 [9.91]					
191930285	F-369-58	---	---	58	.656 [16.66]					
191930287	F-370-12	---	---	12	.515 [13.08]	1.260±.010 [32.00±0.25]	.989 [25.12]	1.497 [38.02]	2.158 [54.81]	---
191930289	F-370-34	---	---	34	.781 [19.84]					
191930291	F-370-38	---	---	38	.390 [9.91]					
191930293	F-370-58	---	---	58	.656 [16.66]					

- NOTES:
- MATERIAL: COPPER
PLATING: ELECTRO-TIN (.0003 MIN).
 - BRAZED SEAM
 - WIRE SIZE: 4 AWG
25 MM²
 - "UL" LISTING #E32244
"CSA" LISTING #18689
 - ALL DIMENSIONS IN INCHES/[MM].
 - PARTS ARE ROHS COMPLIANT.
 - DIMS. SHOWN ARE FOR REFERENCE ONLY.

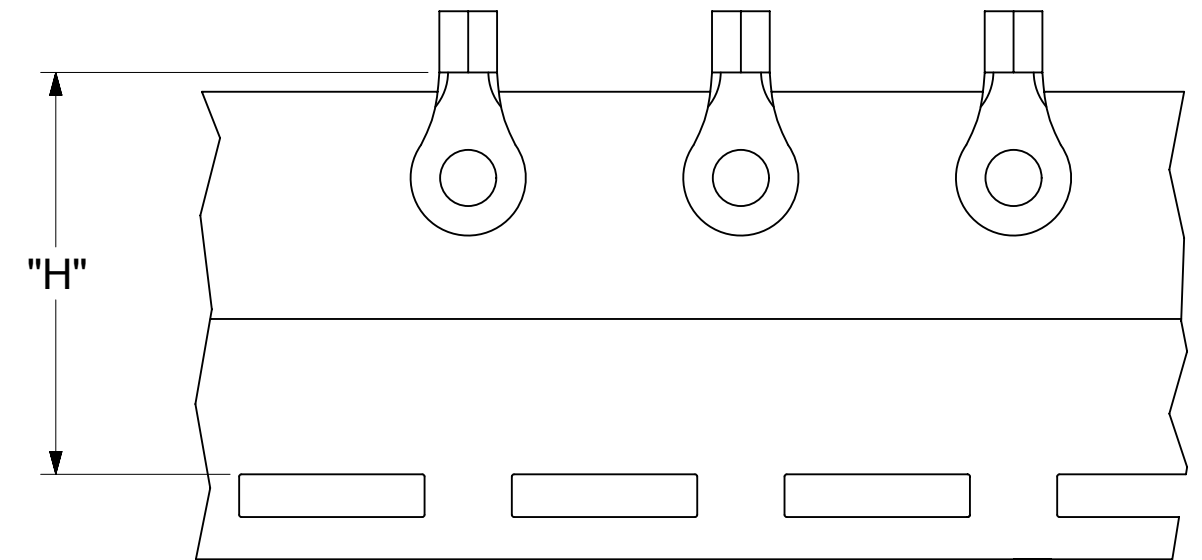
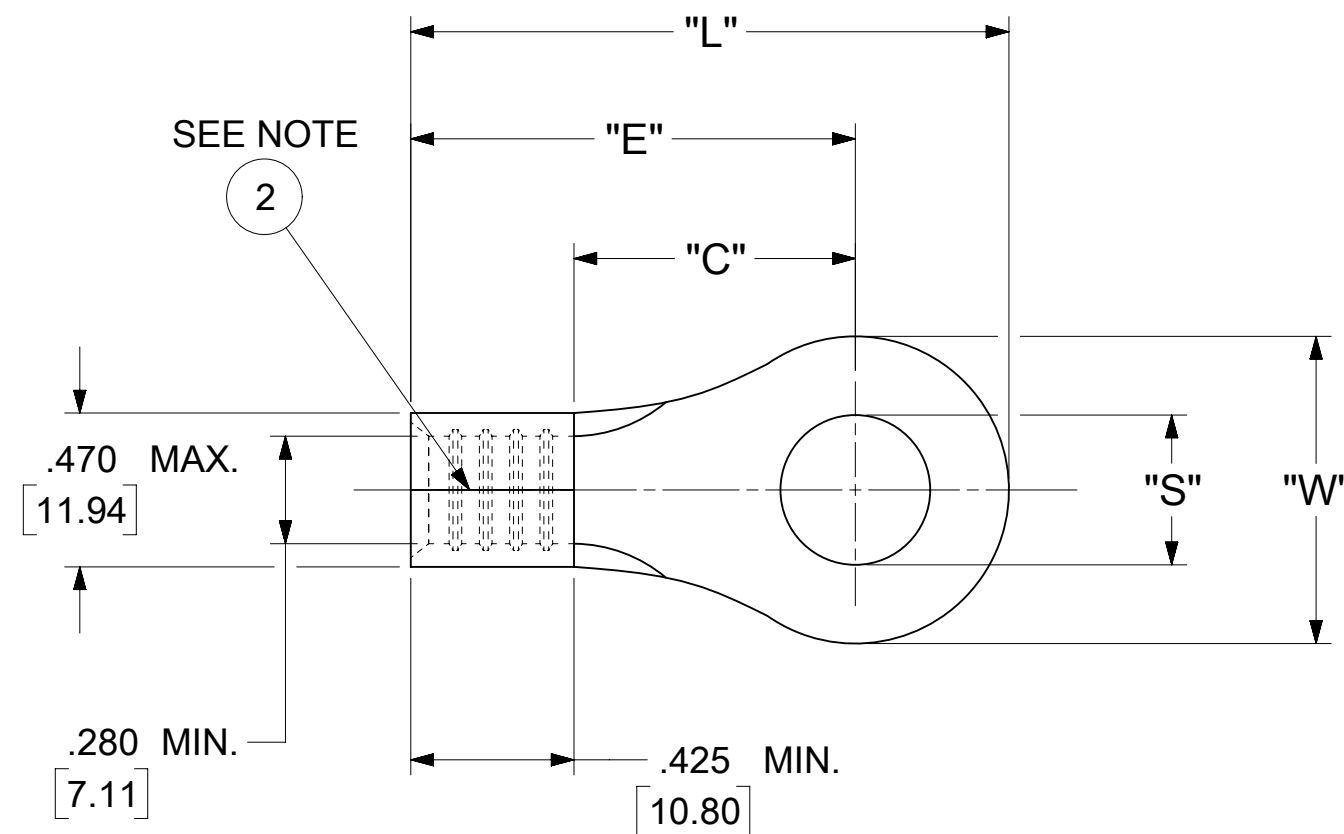

PARTS ON TAPE

THIS DRAWING CONTAINS INFORMATION THAT IS PROPRIETARY TO MOLEX ELECTRONIC TECHNOLOGIES, LLC AND SHOULD NOT BE USED WITHOUT WRITTEN PERMISSION									
DIMENSION UNITS		SCALE		CURRENT REV DESC: REMOVED OBSOLETE PART NUMBERS AS PER PCN#515181					
INCH/MM		NTS							
GENERAL TOLERANCES (UNLESS SPECIFIED)				EC NO: 793824		2024/05/22		RING TONGUE TERMINAL VERSAKRIMP	
				DRWN: MADHAM5		2024/08/14			
4 PLACES ±				CHK'D: GGA		2024/08/14		PRODUCT CUSTOMER DRAWING	
3 PLACES ±				APPR: GGA		2024/08/14			
2 PLACES ± 0.13				INITIAL REVISION:		DOCUMENT NUMBER		DOC TYPE DOC PART REVISION	
1 PLACE ± 0.25				DRWN: LEM		1970/03/02		191930254	
0 PLACES ±				APPR: JMACNEIL		2019/08/06		PSD 000 A1	
ANGULAR TOL ± 0.5 °				THIRD ANGLE PROJECTION		DRAWING		SERIES	
DRAFT WHERE APPLICABLE MUST REMAIN WITHIN DIMENSIONS						C-SIZE		19193	
DOCUMENT STATUS		RELEASE DATE		MATERIAL NUMBER		CUSTOMER		SHEET NUMBER	
P1		2024/08/14 08:26:33		SEE TABLE		GENERAL MARKET		1 OF 1	