



UL Approved Illuminated Rocker

## Specifications

Electrical Ratings	UL61058-1	Actuation Forces	500 ± 200gF
	20A@125VAC, General Purpose, T105/55	Dielectric Strength	1500Vrms min. @sea level, contact to contact
	16A@250VAC, General Purpose, T105/55	Insulation Resistance	≥ 1000MΩ min
	1hp@250VAC; 3/4hp@125VAC	Operating Temperature	-40°C to +85°C
Electrical Life	10,000 cycles, typical	Storage Temperature	-40°C to +85°C
Contact Resistance	≤ 50mΩ initial	Sealing Degree	IP40

## Materials

Actuator	Polycarbonate (PC) or 6/6 Nylon
Housing	6/6 Nylon
Terminals	Copper Alloy, Silver Plated
Contacts	Silver Alloy
Internal Armature	Copper Alloy

## Ordering Information

1. Series	RN	1	2	2	D	W	C	R12
RN								
2. Switch Function								
1* = OFF - NONE - ON								
2 = OFF - NONE - (ON)								
3 = (OFF) - NONE - ON								
4 = ON - NONE - ON								
5 = ON - NONE - (ON)								
6 = ON - OFF - ON								
7 = (ON) - OFF - (ON)								
8 = ON - OFF - (ON)								
<i>*illumination only available with this function</i>								
3. Housing Color								
1 = White								
2 = Black, standard								
9 = Gray								
4. Actuator Color								
1 = White	3T = Red Transparent							
2 = Black	4T = Yellow Transparent							
3 = Red	5T = Green Transparent							
6 = Orange	7T = Blue Transparent							
9 = Gray	2L = Black with Transparent Lens							
5. Marking								
A	G							
B	H							
C	I							
D	J							
E	K							
F								
6. Actuator Marking Color								
A = No Marking								
B = Black								
W = White								
R = Red								
7. Terminal Style								
C = .250" Quick Connect / Solder Lug								
8. Lamp Option								
Blank = Non-illuminated	G12 = Green LED 12V							
N1 = 125VAC Neon Lamp	G24 = Green LED 24V							
N2 = 250VAC Neon Lamp	B12 = Blue LED 12V							
R12 = Red LED 12V	B24 = Blue LED 24V							
R24 = Red LED 24V	W12 = White LED 12V							
Y12 = Yellow LED 12V	W24 = White LED 24V							
Y24 = Yellow LED 24V								

## Dimensions

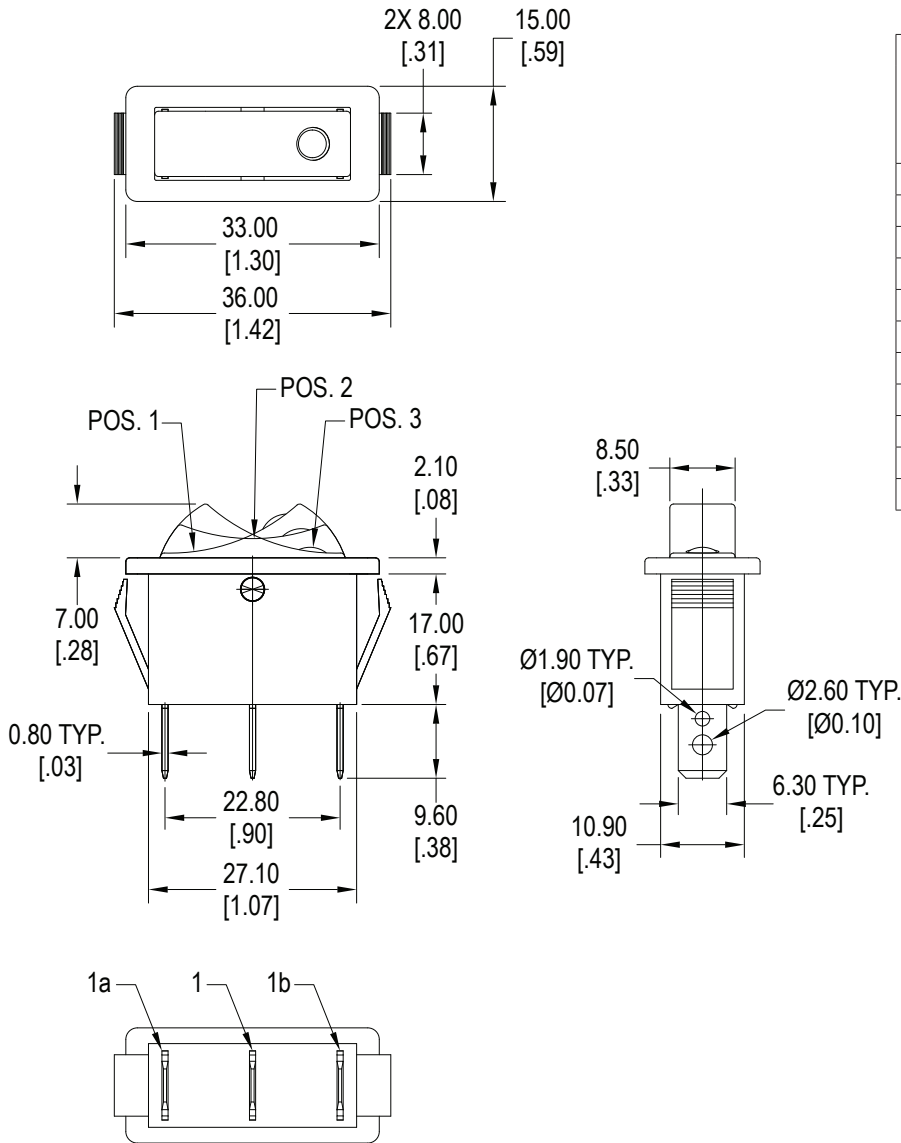

Function	Rocker Position		
	Pos 1	Pos 2	Pos 3
1*	OFF	NONE	ON
2	OFF	NONE	(ON)
3	(OFF)	NONE	ON
Terminals	—	—	1 ~ 1a
4	ON	NONE	ON
5	ON	NON	(ON)
6	ON	OFF	ON
7	(ON)	OFF	(ON)
8	ON	OFF	(ON)
Terminals	1 ~ 1b	—	1 ~ 1a

### Schematic & Panel Cut Out

SPST, Non-Illuminated

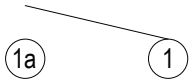

SPST, Illuminated, Neon Bulb

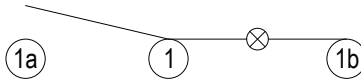

SPST, Illuminated, LED

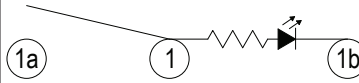

SPDT, Non-Illuminated

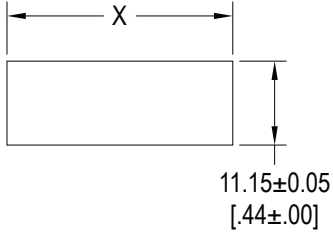
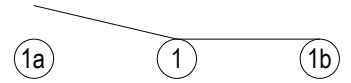

Panel Thickness	X
0.70 ~ 1.25	29.60 ~ 29.70
1.25 ~ 2.00	30.10 ~ 30.20
2.00 ~ 3.00	30.45 ~ 30.55

### Actuator Marking Options

A Marking

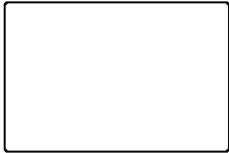

B Marking

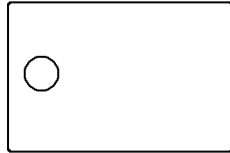

C Marking

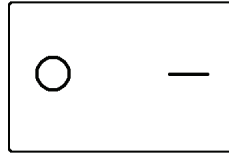

D Marking

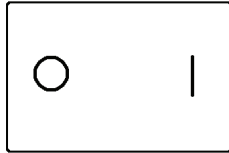

E Marking



F Marking



G Marking

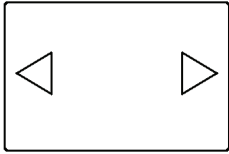

H Marking

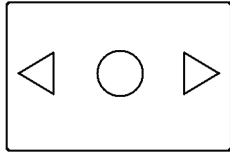

I Marking

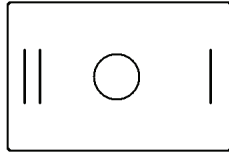

J Marking

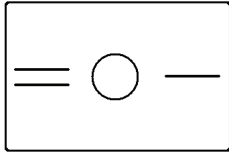

K Marking



### LED Characteristics

LED Ratings		Color					Units
		R	Y	G	B	W	
Reverse Voltage	$V_R$	5	5	5	5	5	V
Forward Current (avg)	$I_F$	30	30	30	30	30	mA
Reverse Current $V_R = 5V$	$I_R$	10	10	10	10	10	$\mu A$
Power Dissipation	$P_T$	56	56	46	72	76	mW
Operating & Storage Temperature	$T_A$	-40 ~ +85					C°
Forward Voltage (min) $I_F = 20mA$	$V_F$	1.7	1.7	1.8	2.8	2.8	V
Forward Voltage (max) $I_F = 20mA$	$V_F$	2.4	2.4	2.4	3.4	3.4	V
Wavelength (min) $I_F = 20mA$	$\lambda_d$	620	585	565	460	n/a	nm
Wavelength (max) $I_F = 20mA$	$\lambda_d$	630	595	575	470	n/a	nm
Luminous Intensity, $I_F = 20mA$	LI	50	150	30	140	500	mcd
Viewing Angle	$\Theta$	50	50	70	120	70	deg